

Příloha č.1 k prohlášení vlastníka domu č.p.527 na jednotky

ČÍSLO POPISNÉ: 527

ULICE: NA SPOJCE

KAT.ÚZEMÍ: VRŠOVICE

OBEC: PRAHA 10

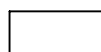

- BYTOVÉ JEDNOTKY



- SPOLEČNÉ PROSTORY



- BEZPODLAHOVÉ PLOCHY



- NEBYTOVÝ PROSTOR



- BALKONY, TERASY

**1.P.P.
Na Spojce 16**

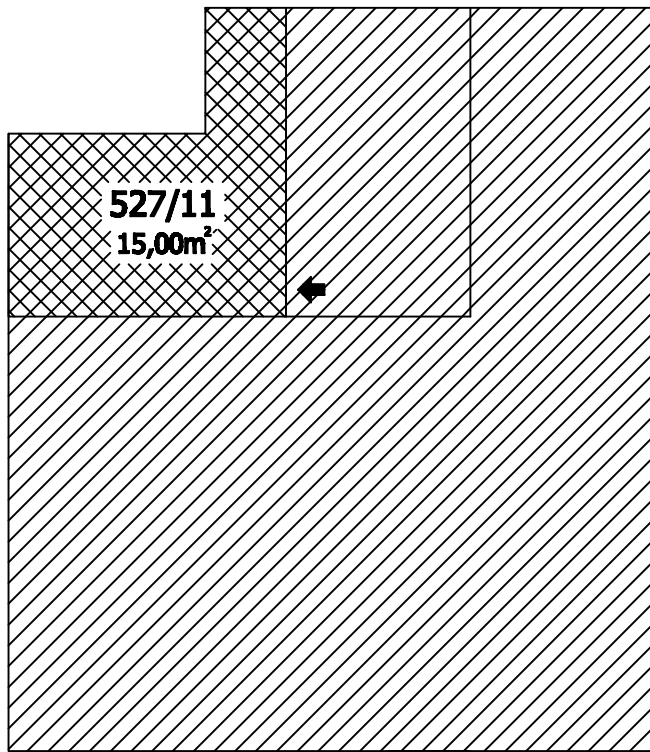

**1.N.P.
Na Spojce 16**

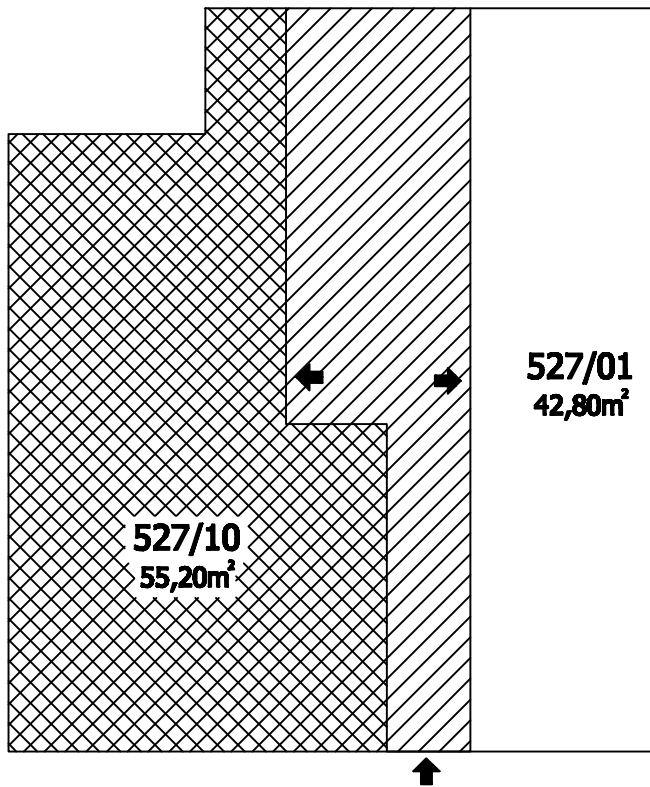

**2.N.P.
Na Spojce 16**

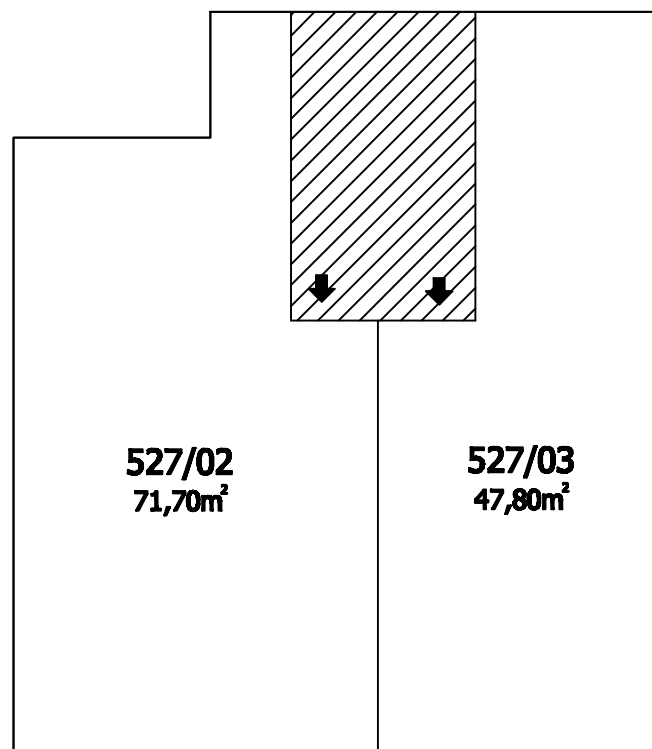

**3.N.P.
Na Spojce 16**

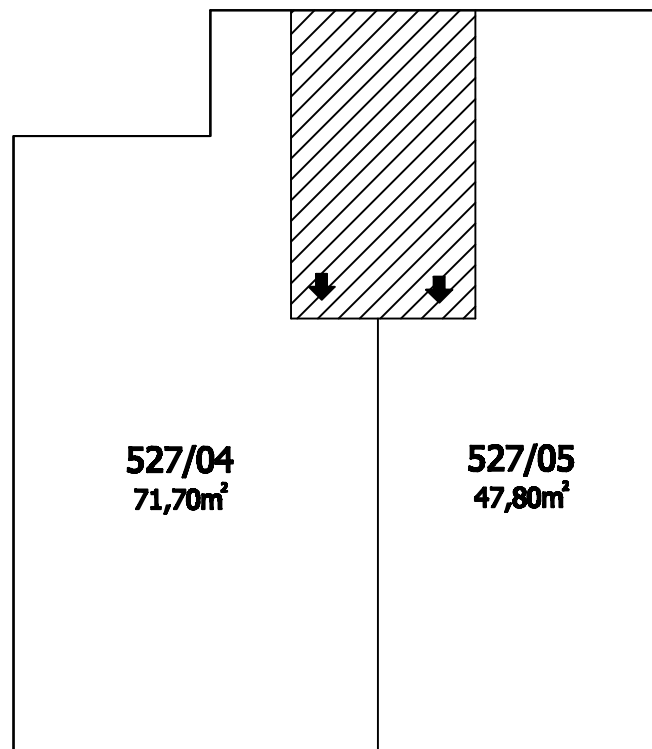

**4.N.P.
Na Spojce 16**

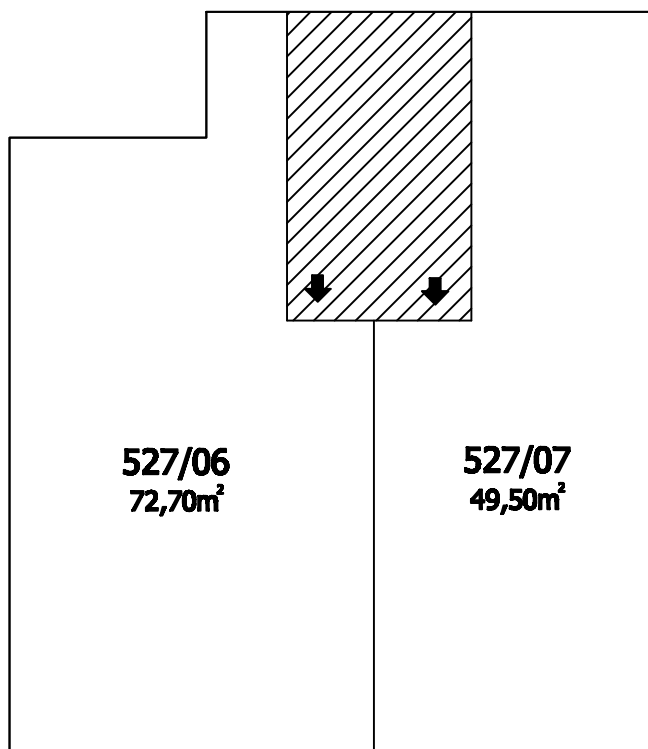

**5.N.P.
Na Spojce 16**

